

| REV | DESCRIPTION  | DATE     | APPROVED |
|-----|--|----------|----------|
| A   | PROTOTYPE DRAWN  | 6/99     | 6/99     |
| B   | ADDED LEADING BARB<br>CHANGE THE DIM:<br>FROM 1.615 TO 1.61<br>FROM .375 TO .372<br>ADDED 5 DEG. & .355<br>FROM .437 TO .430 | 8/99     | 8/99     |
| C   | REDRAWN & RELEASED   | 12/23/99 | BM       |
| D   | UPDATE DWG   | 9/07     | 9/07     |

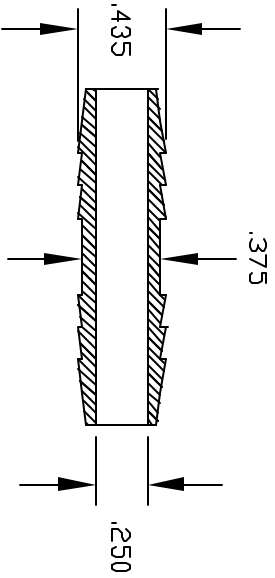
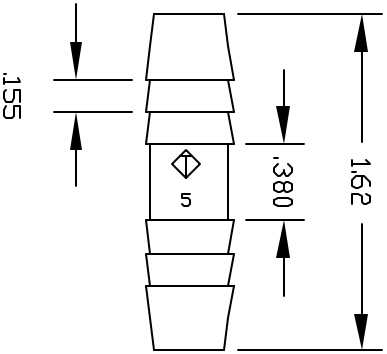

CONTROLLED DOCUMENT  
ONLY IF IN RED

COMMERCIAL  
THIS PRINT AND THE SPECIFICATIONS ARE THE PROPERTY OF THOGUS PRODUCTS COMPANY AND HAVE BEEN ISSUED WITH THE UNDERSTANDING THAT IT SHALL NOT BE REPRODUCED, COPIED, REVEALED TO OR USED FOR THE MANUFACTURE FOR OTHERS AND WILL BE RETURNED UPON REQUEST.

| UNLESS OTHERWISE SPECIFIED DIMENSIONS ARE IN INCHES |         | PART NAME:                            |  |
|---|---------|---------------------------------------|--|
| DECIMALS  | ANGULAR | 3/8 BARB X 3/8 BARB CONNECTOR         |  |
| .XX +/- .05   | +/- .05 |                                       |  |
| .XXX +/- .015                                       |         |                                       |  |
| DRAWN   | DATE    | THOGUS PRODUCTS 33490 PIN OAK PARKWAY |  |
| BM  | 12/99   | AVON LAKE OHIO 44012                  |  |
| FILENAME:   |         | PART NUMBER                           |  |
| Z066N   |         | TC7066/N                              |  |
| MATERIAL  |         | SHEET 1 OF 1                          |  |
| NYLON   |         | REV D                                 |  |