

REVISIONS			
REV	DESCRIPTION	DATE	APPROVED
A	RE-DRAWN & RELEASED	1/98	1/98
B	UPDATE DWG	9/07	9/07

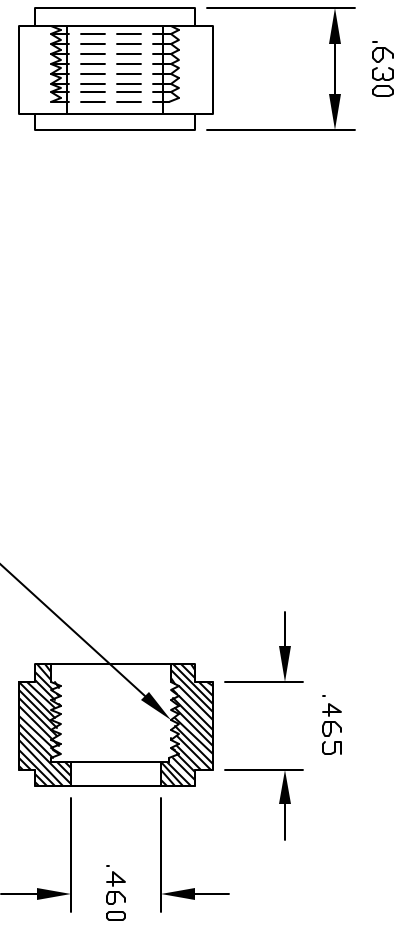

TO MATE WITH THOGUS INSERT ADAPTER  
SNA6, 3/8" INSERT

CONTROLLED DOCUMENT  
ONLY IF IN RED

**CONFIDENTIAL**  
THIS PRINT AND THE SPECIFICATIONS ARE THE PROPERTY OF THOGUS PRODUCTS COMPANY AND HAVE BEEN ISSUED WITH THE UNDERSTANDING THAT ALL INFORMATION CONTAINED HEREIN IS UNCLASSIFIED AND WILL BE RETURNED UPON REQUEST.

UNLESS OTHERWISE SPECIFIED DIMENSIONS ARE IN INCHES		TOLERANCES	
DECIMAL	FRACTIONS	ANGLES	PLACES
XX +/- .05	1/16	± .05	
XXX +/- .015			
DRAWN	DATE	Part Number	
NM	1/98	3/8 NPT FEMALE	SWIVEL NUT
DESIGNED		THOGUS PRODUCTS 33490 PIN DAK PARKWAY	
NYLON		AYDON LAKE OHIO 44012	
Material		Part Number	REV
NYLON		SNA6/N	B
		SHEET 1	of 1